



Smart Motion 01

Wi-Fi-enabled PIR (Passive Infrared)
motion sensor

Technical Specifications:

USB input voltage: DC5V/2A
Battery: DC3V LR03*2
Detection distance: 5 meters
Working temperature: -10~+40 degrees

**Please note that the battery and USB
connection cannot work at the same time.**

Warranty

Sundirect offers a 2-year manufacturing warranty on Smart Motion 01. Within the warranty period from the date of purchase, Sundirect will repair or replace your Smart Motion 01 if the fault is due to defects in workmanship or materials. Please contact your local Sundirect dealer in the event of a warranty claim and return the control box together with proof of purchase.



Operation instruction

Wi-Fi and APP operation via Sundirect Smart APP

1. Scan the QR code on the right to start to download the APP, or download the APP "Sundirect Smart" from the App Store or Google Playstore. Open the APP and register with your phone number or Email address.
2. Power on the Smart Motion 01 either using the battery or it can be directly supplied by a USB connection. However, please note that once the USB connection is used, the battery must be removed from the Smart Motion 01. Please make sure you follow this step, otherwise, it will cause failure to the Smart Motion 01 and it won't be covered by the warranty.
3. Insert the pin into the hole of the Smart Motion 01, move the pin until you see the signal light on the Smart Motion 01 start to flash. The signal light flashing rapidly means the Smart Motion 01 is under the EZ mode while the signal light flashing slowly means the Smart Motion 01 is under AP mode. Each press of the pin will change between the two Wi-Fi connection modes.
4. Connect the Smart Motion 01 to the APP by following the steps indicated in the APP. If you manually add the device, you can choose the category of "thermostat".

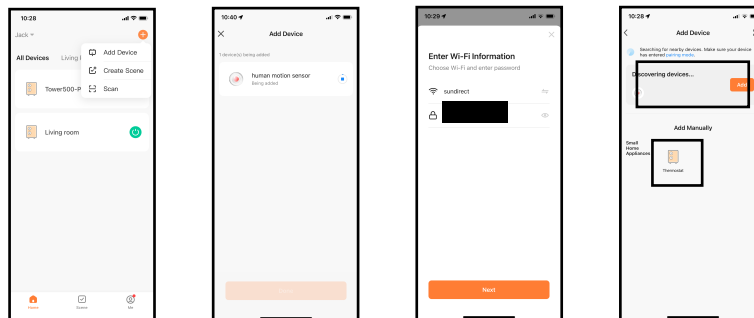

If you fail to connect, please try another Wi-Fi connection mode by inserting the pin into the hole of the Smart Motion 01 again and retry the connecting process.

After successfully connecting the Smart Motion 01 to the APP, you are able to link the Smart Motion 01 to other Sundirect Smart devices.

On the other side of this manual is an example of setting up automation between the Smart Motion 01 and one of our Wi-Fi heaters using the scene function. We would like to decrease the temperature to 14 degrees when the sensor detects that there is nobody in the room. This is just an example to show how to set up the automation.

You can create your own unique program to fulfill your needs with the scene function.

Here's an example of how you can set up automation between the Smart Motion 01 and one of the Sundirect Smart Wi-Fi heaters using the scene function:

